



Pump specifications:

Type.....	BA75 D220
Max. flow	100 m ³ /hour (440 US GPM)
Max. pressure	17 mwc (56 ft.)
Solids handling	42 mm (1,65")
Impeller type	Open impeller
Priming system	BBA MP50
Engine	Hatz 1D81Z
Emission standard	Stage V
Canopy	L9-15
Connections.....	3" quick couplings
Sound level.....	Approx. 50 dB(A) at 10 m
Dry weight.....	875 kg (1925 lbs.)

FEATURES

BA auto prime pump

The BA range of pumps has been designed with a clear focus on reliability, efficiency and durability. Featuring a 100% mechanical priming system, the BA series pumps quickly prime and re-prime, even from dry conditions. The heavy build style of both pump and canopy make the BA range perfect for use in the strenuous contractor market.

World-class performance

The BA range is built to be deployed on the most demanding dewatering and sewage bypassing applications. Using high efficiency pumps and state-of-the-art diesel engines, the pumps offer maximum performance at minimal cost, fully in-sync with the company philosophy of "Lowest cost of ownership".

Sustainability

- High efficiency pumps minimising fuel consumption
- Corrosion free hot dip galvanized canopy
- Corrosion free composite door panels
- 100% Oil-spill free priming system
- Fully bundled unit eliminating fuel/oil spills at all times

Complete package designed & built by BBA Pumps

- Complete in-house design & production
- Over 60 years of experience in the market
- Extensive testing facility in-house
- Contemporary & functional design
- Durable & eco-friendly materials
- Custom builds available

After sales service & product support

- Single supplier for parts, spares & accessories
- Dedicated customer help-desk (24h service)
- Dedicated service department in-house
- Global parts distribution network
- Optional global on-site servicing
- Extensive training options available (technical & commercial), on-site or in-house

PERFORMANCE CURVES (1500 RPM)

Continuous duty according ISO 9906

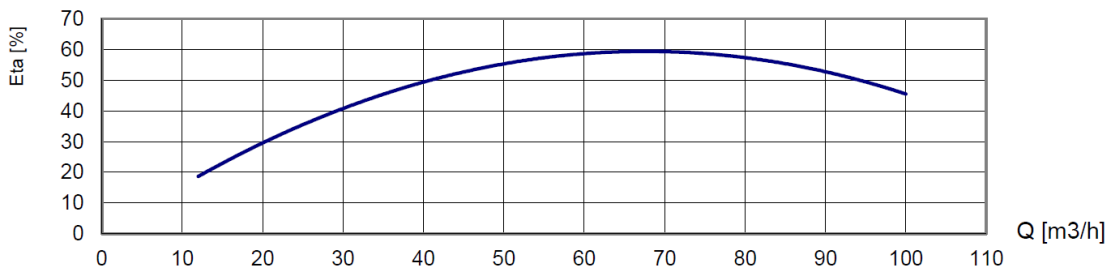
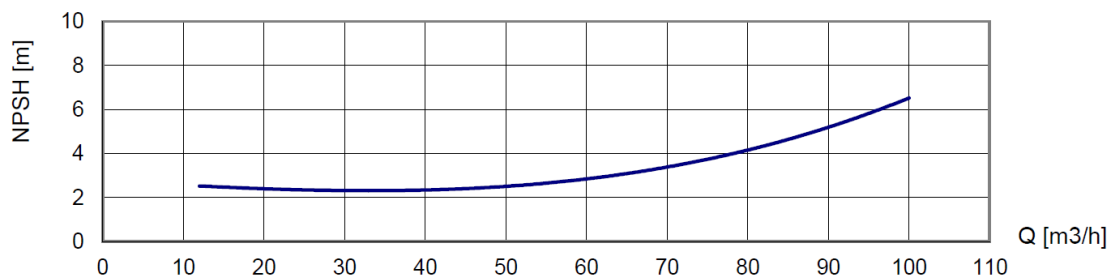
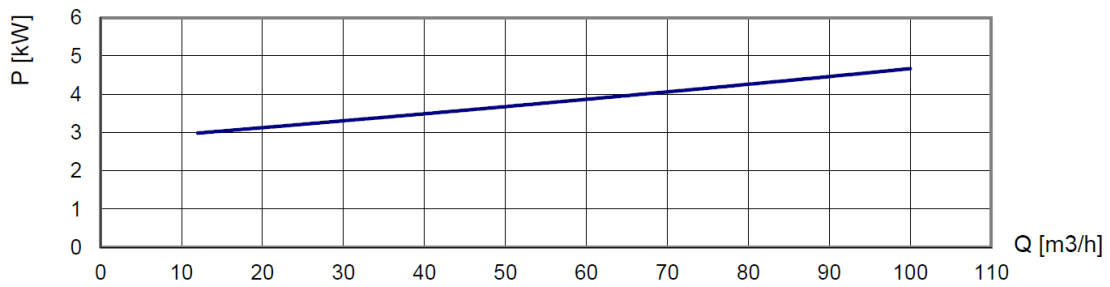
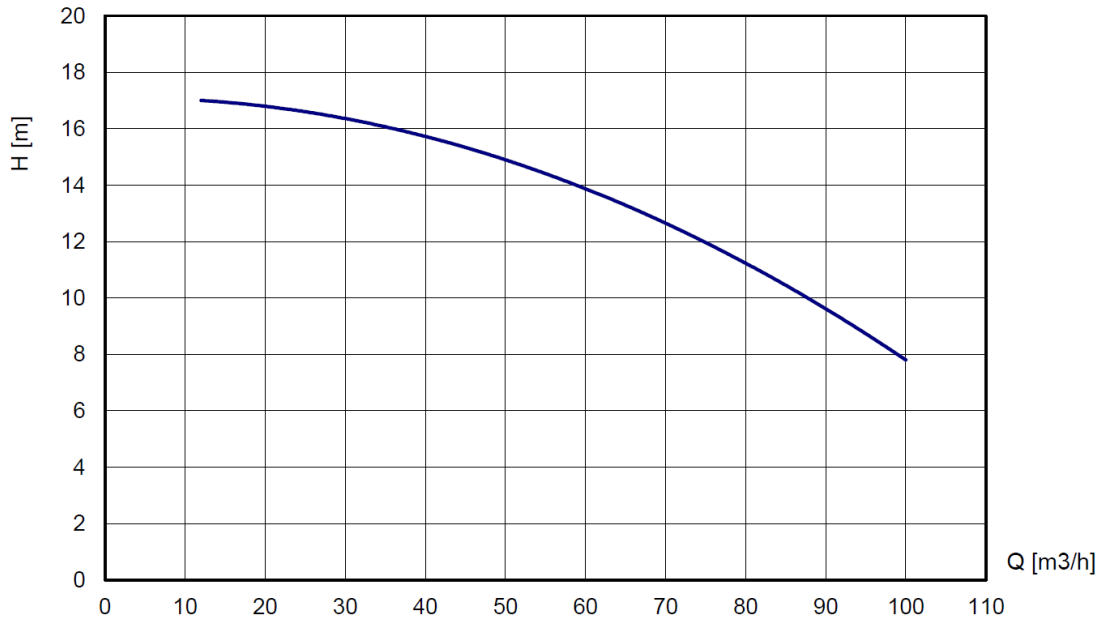

STANDARD TECHNICAL SPECIFICATIONS

BBA auto prime pump

Pump type.....BA75 D220
 Max. flow..... 100 m³/hour (440 US GPM)
 Max. head..... 17 mwc (56 feet)
 Impeller type Open impeller
 Solids handling 42 mm (1.65 inch)
 Pump casing St. 37 galvanized
 Impeller Cast iron GG20
 Wear plate Cast iron GG20
 Pump shaft..... C45
 Shaft seal..... Mechanical seal
 Seal faces Tung/Tung
 Seal rubber Viton



BBA priming system

Pump type.....BBA MP50 Diaphragm pump
 Air handling capacity 50 m³/h (30 CFM)
 Max. vacuum 8.5 m (29 inHg)
 Drive Toothed belt (continuous drive)
 Float box St. 37 galvanized
 Float..... Stainless steel
 Non return valve Cast iron GG25



Engine

Engine brand Hatz
 Engine type..... 1D81Z electric start
 Power..... 5.5 kW (7.5 Hp)
 Engine speed..... 1300 - 1500 RPM
 Fuel consumption 245 g/kWh
 Displacement..... 0.667 l (40,7 cu.in.)
 Number of cylinders..... 1
 Cooling system Air cooled
 Starting method Electric start/stop
 Emission level..... Stage V



Control panel

- Auto start/stop system
- Two float switches included (10 m cable)
- Switch Manual-0-Auto
- Hour counter
- Warning lights

Fuel system

- Composite fuel tank 120 Litres (32 US Gallon)
- Fuel tank cap Ø 60 mm (2.5 inch)
- Mechanical fuel injection system
- Fuel filter / water separator

Electrical system & safety features

- Nominal voltage 12 Volt
- Premium quality battery
- Low oil pressure shut down

CANOPY L9-15

BBA Super Silent Canopy

- Canopy type.....L9-15
- Dimensions L x W x H 1500 x 940 x 1228 mm
- Dimensions L x W x H59 x 37 x 48,3 inch
- Basic frame Hot dip galvanized
- Doors 6 easy-access doors (lockable)
- Roof panel Composite
- Fuel tank Composite net 120 ltr (32 US Gallon)
- Fuel tank autonomy 85 hours (at 1500 rpm.)
- Fuel tank cap 60 mm (2.5 inch)
- Lifting point Fitted with single lifting point
- Forklift pockets..... Fitted with 2 forklift pockets
- Stackable Canopy is stackable
- Connections..... Please consult “auxiliary items”
- Exhaust system Fully integrated in canopy
- Documentation box..... BBA user manual and warranty book

BBA E-lift® system

The L9-15 canopy has been fitted with the BBA E-lift® system. By removing the roof panel, the pump and diesel engine as a whole can be removed from the canopy effortlessly allowing easy preventative maintenance on the pump and diesel engine. In addition, as the canopy is not fitted with padding or insulation materials, it can be cleaned quickly using a pressure washer.

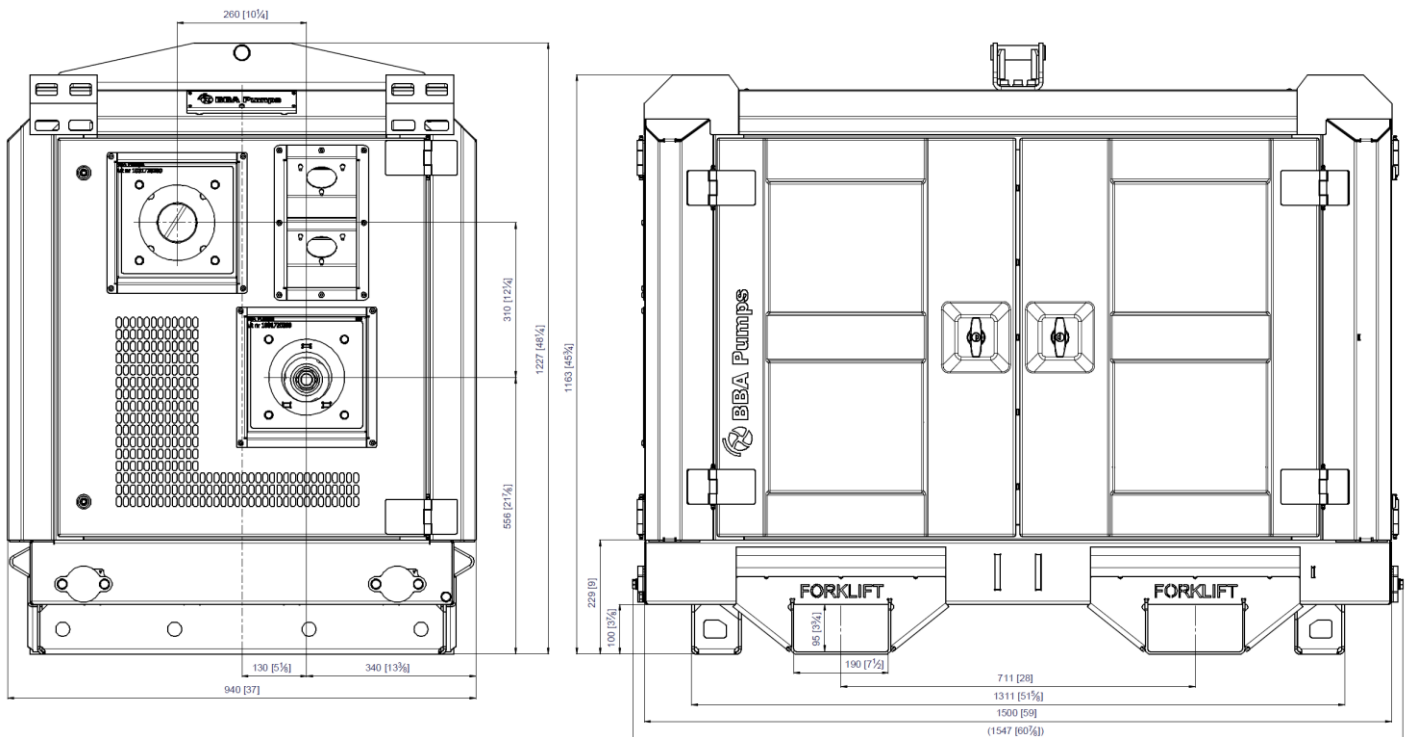

Actual dimensions (in mm and inches) may vary depending on selected quick couplings.

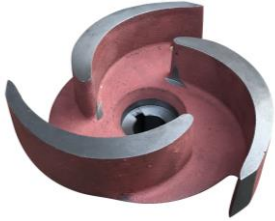

Open impeller
Robust open impeller with large 42 mm free passage in combination with heavy duty wear plate for a long working life.



Priming system
Diaphragm pump, air-cooled, water-resistant and oil-spillage free. Air capacity of 50 m³ per hour.



Fuel tank
Fully bunded, corrosion-free, 120 liter, high-density polyethylene (HDPE) fuel tank.

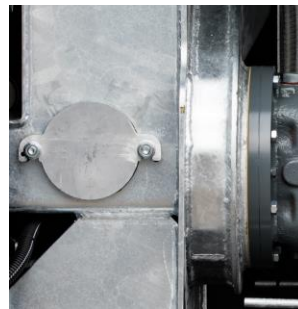

Large inspection covers
Easy access to float box, impeller and non-return valve.

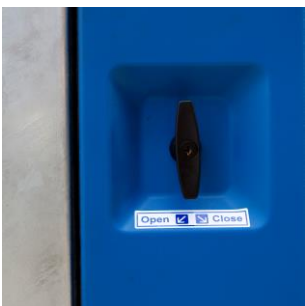

Safety
Extremely durable and lockable T-locks offering perfect grip.



4 Year limited warranty
The BBA limited warranty covers years or operating hours whichever occurs first. For more details please consult the BBA warranty book.

Pictures used are for illustration purposes only.

AUXILIARY ITEMS (configurable)
Discharge connections

Art.nr.		Ø inch	Ø mm	Connection	
26089	30° male (ball)	3	75	System C	
26102*	20° male (ball/lever)	3	75	System B	
26090	30° female (cup)	3	75	System B	
32345	30° ANSI flange	3	75	Flange	

*To open the front door the connection has to be removed.

Suction connections

Art.nr.		Ø inch	Ø mm	Connection	
26089	30° male (ball)	3	75	System C	
26090	30° female (cup)	3	75	System B	
17123*	20° male (ball)	4	100	System C	
5080878*	30° male (ball)	4	100	System B	
14056	20° female (cup)	4	100	System B	
5080880*	30° DIN flange	4	100	Flange	

*To open the front door the connection has to be removed.

Suction hoses

Art.nr.	BBA Flex rubber suction hose	Ø inch	Connection	
26662	3 meter hose with male x female	3	System C	
26671	4 meter hose with strainer x female	3	System C	
26672	3 meter hose with male x female	3	System B	
26673	4 meter hose with strainer x male	3	System B	

Recommended suction pipe ID vs flow rates by pipe dimension (maximum velocity = 4 m/sec)

m ³ /h	L/sec	2" 50	3" 75	4" 100	5" 125	6" 150	8" 200
28.8	8	4.07	1.81	1.02	0.65	0.45	0.25
36	10	5.09	2.26	1.27	0.81	0.57	0.32
43.2	12	6.11	2.72	1.53	0.98	0.68	0.38
50.4	14	7.13	3.17	1.78	1.14	0.79	0.45
57.6	16	8.15	3.62	2.04	1.30	0.91	0.51
64.8	18	9.17	4.07	2.29	1.47	1.02	0.57
72	20	10.19	4.53	2.55	1.63	1.13	0.64
90	25	12.73	5.66	3.18	2.04	1.41	0.80
108	30	15.28	6.79	3.82	2.44	1.70	0.95